



SCHLAGE

L Series

Grade 1 mortise locks

- Mechanical
- Wired electrified
- Wireless electronic
- Multi-point



Mortise lock comparison

L mechanical

**Applications**

The Schlage L Series has long been the benchmark for mortise locks. Beyond strength and security – it offers tremendous flexibility to allow it to meet the needs of most every application.

The ability to suite across electronic, tubular, exit trim, and multi-point locks allows the Schlage L Series mortise lock to integrate seamlessly into any environment.

Key features

- Exceeds ANSI/BHMA Grade 1 operational and security standards
- Expansive list of configurations and options, including retrofit indicators
- 50 standard mechanical functions, custom functions also offered
- “The Original” universal lock case allows creation of 10 functions from a single lock body
- 14 finishes and 33 levers, two knobs, five roses and three escutcheon designs
- Supports standard, SFIC and FSIC cylinder formats
- Multiple key systems available – open, patented, restricted, geographic exclusive, UL 437

L wired electrified

**Applications**

The wired electrified L Series is ideal for new construction and high traffic areas where hardwired power ensures continuous operation and where electrified door prep, hinges and wiring can easily be incorporated into the building.

The electrified L Series is regularly used as part of an access control system for high security areas, or independently in areas that require a remote access switch.

Key features

All mechanical features plus:

- Auto-detect 12/24 VDC
- Selectable EL/EU
- 10 electrified functions
- Advanced features: RX, DPS, latchbolt monitor and deadbolt monitor for application flexibility
- Leading energy efficiency that eliminates “hot levers”
- Advanced motor-driven electrified functions – quieter, smoother, more secure operation

LE wireless electronic

**Applications**

The Schlage LE wireless mortise lock with ENGAGE™ technology is designed to affordably extend electronic access control deeper into the building beyond traditional perimeter and high security openings.

The LE is ideal for commercial real estate, K-12, higher education, assisted living, medical offices, or multi-family applications. Facilities can benefit from the enhanced security, efficiency, and convenience of upgrading to electronic credentials.

Key features

All mechanical features' plus:

- Six functions with LED indicator, deadbolt, and interior pushbutton options
- Sectional and escutcheon trim options
- 31 levers, 2 knobs and 9 finishes
- Integrated multi-technology card reader, door position sensor (DPS) and request to exit (RX)
- Built-in Bluetooth® enables wireless configuration from smart phones/tablets
- Built-in Wi-Fi® enables automatic daily updates sent directly from host software
- Capable of networked real-time communication with the ENGAGE Gateway and software alliances
- Up to 2 years of battery life

L400 mechanical



Applications

L400 Series locks are designed for use as primary locks where no latching is required, such as restrooms and small doors to utility spaces.

It also offers optimum security when used as an auxiliary lock in other applications.

Key features

- Six available functions
- 12 finishes
- 1" (25 mm) stainless steel throw deadbolt
- Deeper retainer groove in cylinder shell increases security against wrenching and pullout; all cylinders backward compatible
- 6-pin Everest® 29 cylinder with patented keys standard
- Steel case and parts are corrosion resistant

LM9200 multi-point



Applications

The Schlage LM9200 series lock utilizes latches in the top and bottom of the door, rather than the side on single or double sets of doors.

Compatible with wood or hollow metal doors, the LM9200 Series is ideal for conference rooms, corridors, office suites, elevator lobbies, and openings where flush bolts and coordinators are not desired.

Key features

- Concealed vertical cables provide simple installation and reliable performance
- Compatible with sectional and escutcheon trim; does not require "backer plates" or metal wraps for fire protection
- Fire-rated for up to 60 minutes for wood door applications; 90 minute fire rating for hollow metal door applications
- 33 lever designs
- 13 functions (mechanical and electrified)
- Available without the bottom latch for single point latching

LM9300 multi-point

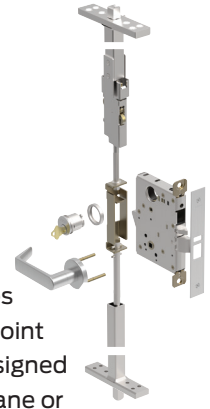

Applications

The LM9300 Series is part of a three-point locking system designed for tornado, hurricane or high security applications, providing superior protection with familiar operation.

Latches at the top, side and bottom of the door provide protection from high wind speeds and 15-lb. projectile impacts up to 100 mph when paired with a Steelcraft Paladin tornado-resistant door.

Key features

- All three latches engage when the door is shut and retract simply by rotating the lever
- Compatible with sectional and escutcheon trim
- 33 lever designs
- Six available functions
- Complies with FEMA 361 and ICC500 tornado shelter guidelines and Florida Building Code Enhanced Protection Area (EHPA) standard when paired with appropriate Steelcraft doors
- Vertical rods ship pre-aligned and pre-installed with Steelcraft doors, enabling quick and simple installation

A detailed look...

L mechanical

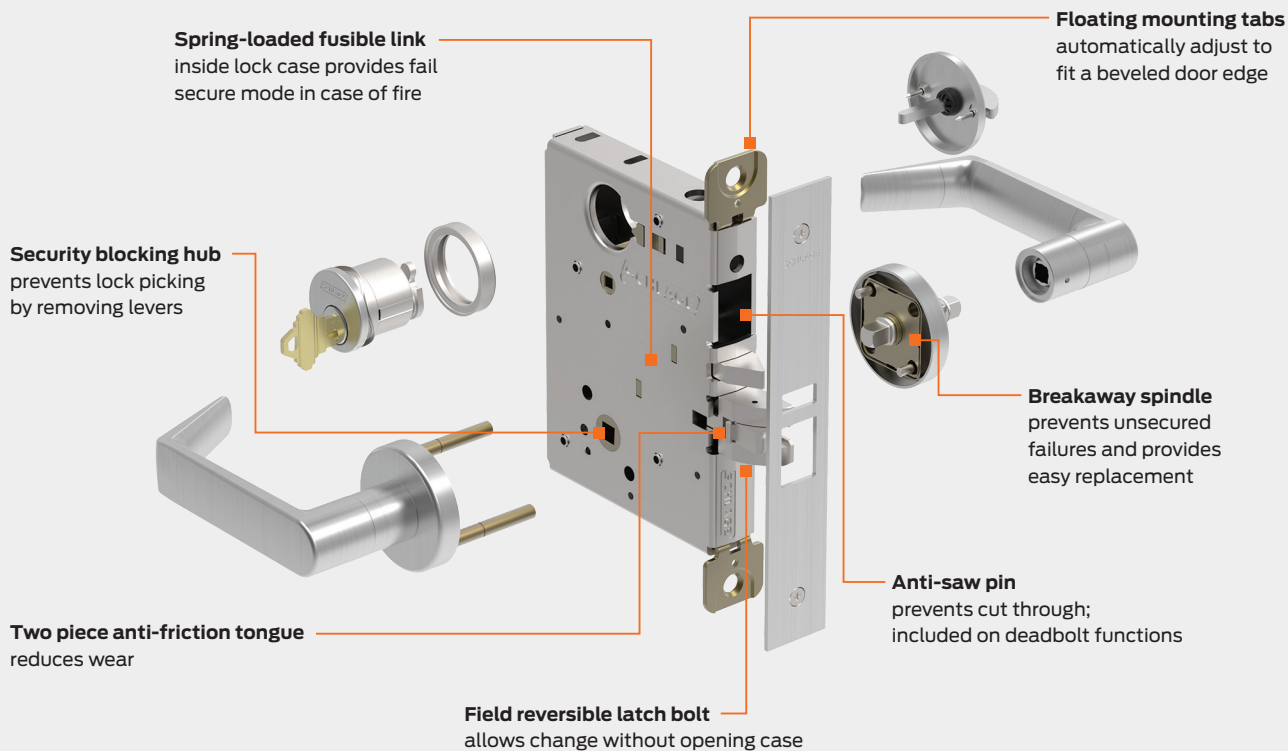

L wired electrified

All mechanical features +

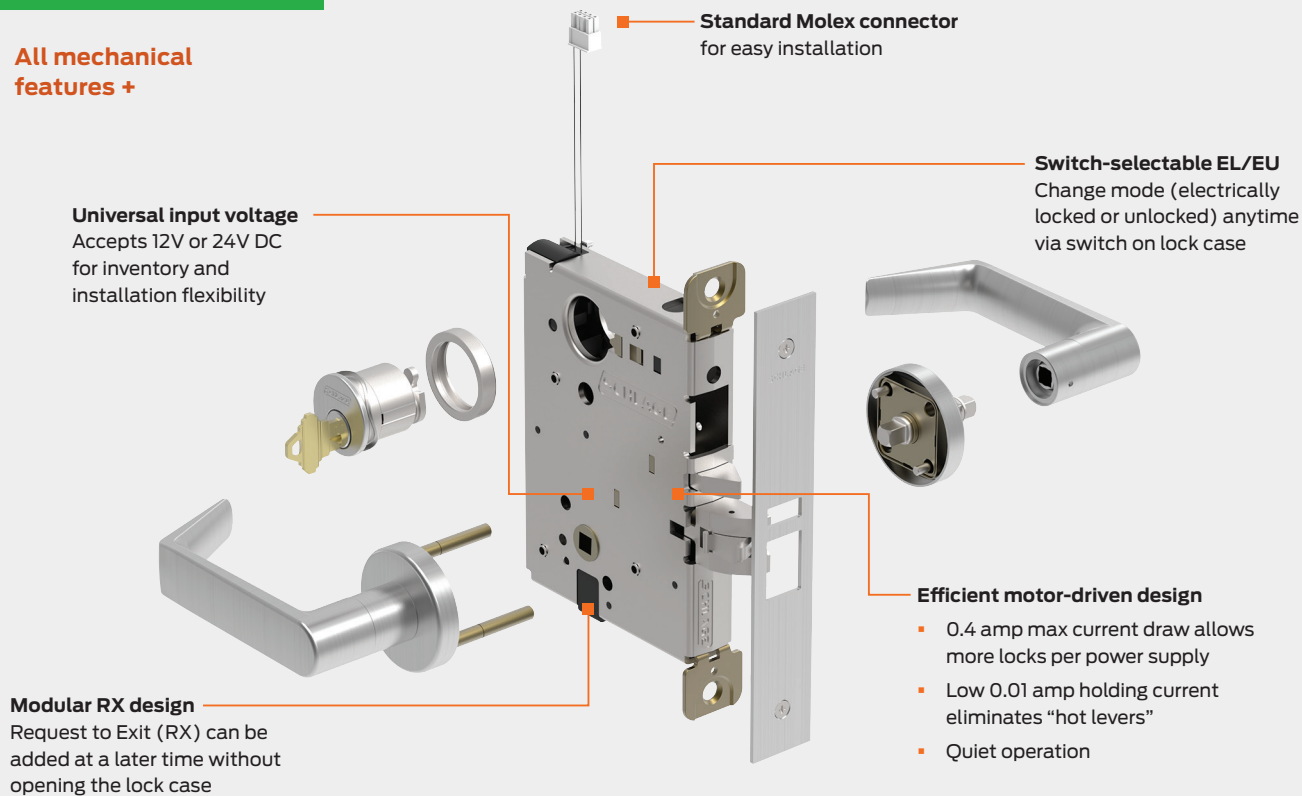

LE wireless electronic

Most mechanical features +

Integrated multi-technology reader
reads both 125 kHz proximity and 13.56 MHz smart credentials

Built-in No-Tour capability
eliminates the need to visit the locks by using smart credentials to update access rights

Mechanical key override
compatible with most popular key systems

Built-in Bluetooth®
enables wireless configuration from smart phones and tablets

Built-in Wi-Fi
enables automatic updates to access rights

Up to 2 years of battery life
with 4 AA batteries

Integrated door position switch
requires no additional prep on MS and MB chassis options

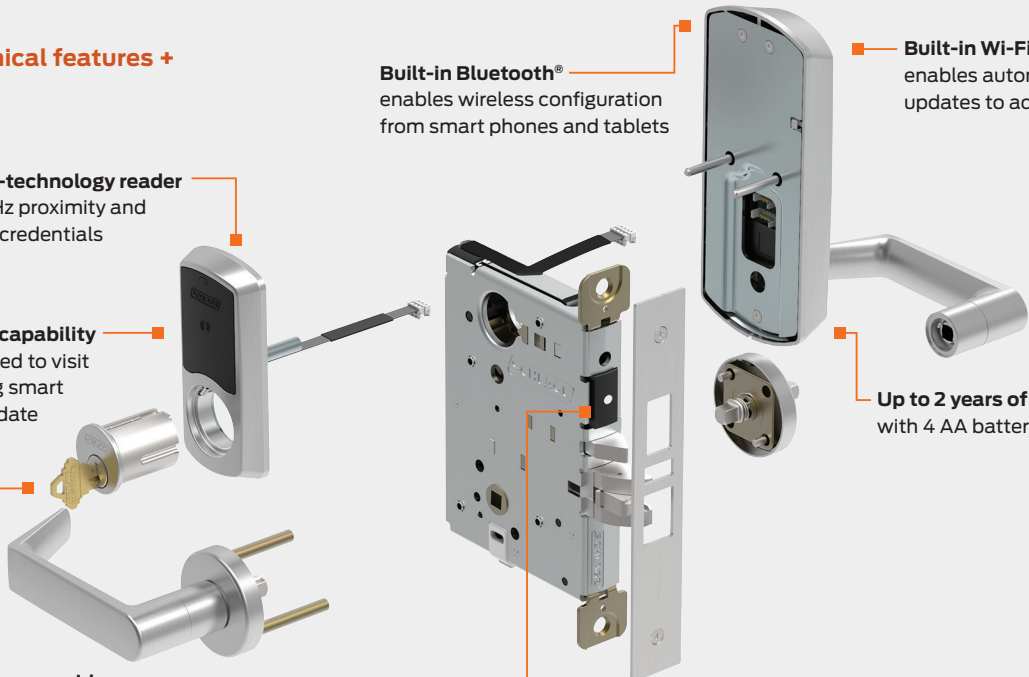

LM9200 multi-point

Fire protection
90 min hollow metal door fire rating; 60 min wood door fire rating with metal wrap

Concealed vertical cables
provide clean look and simple installation

Top and bottom locking points
allow both leaves of a pair of doors to be active via switch on lock case

Suites visually
with Schlage L Series and Von Duprin trim for design continuity

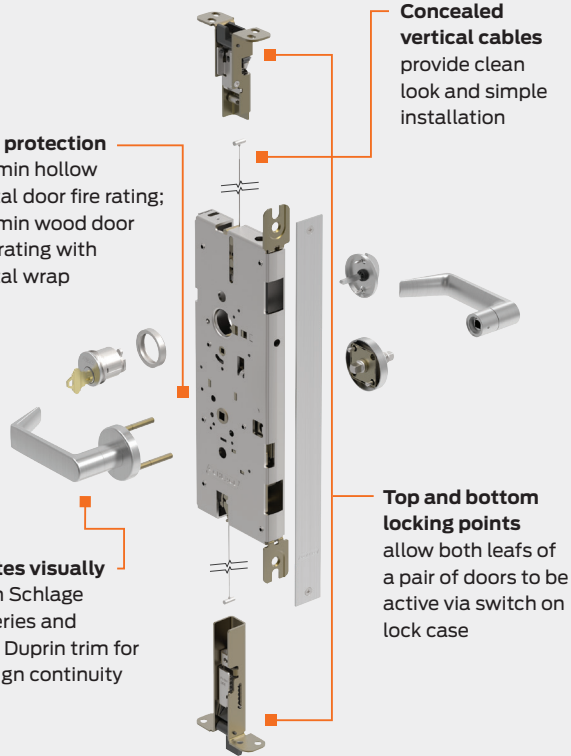

LM9300 multi-point

Vertical rods ship installed and aligned
in Steelcraft doors, enabling quick and simple installation

Flexible installation and removal of lock
can be done with door installed

Three locking points
provide added layer of protection and security

Suites visually
with Schlage L Series and Von Duprin trim for design continuity

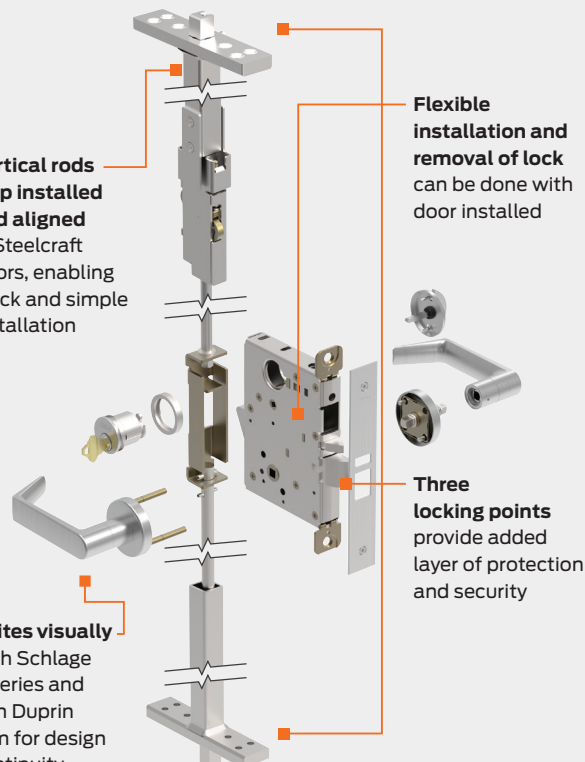







Trim and special accessories

Thumbturns and indicators

Choose from these variations of thumbturn locks that help you meet the demands of specialized projects.

Thumbturns

					
Standard turn 09-509	ADA turn 09-509 x L583-363 Available with all thumbturn-function L Series locks except L9463 and L463	Coin turn L283-124 For lock functions L9044 and L9444 with rose trim.	Emergency button K510-330 For lock functions L9040 and L9440	Ligature resistant turn 09-029	Cylinder turn 09-90x For L463 and L9463 classroom function deadlocks

Indicators

The 180 degree visibility indicator offers unparalleled visibility and flexibility. The unique features of the indicator make it ideally suited for classroom security applications as well as traditional occupied/vacant applications.

- 2" x 1/2" display for easy viewing at a distance
- 180° window for visibility at any angle
- High-mount placement for quick assessment
- High contrast colors for ease of reading
- Available for over 30 functions, inside or outside of door (see Functions section for availability)
- Retrofit kit allows indicator upgrades to already installed L Series mortise locks
- Indicator text available in English or French

N escutcheon indicators

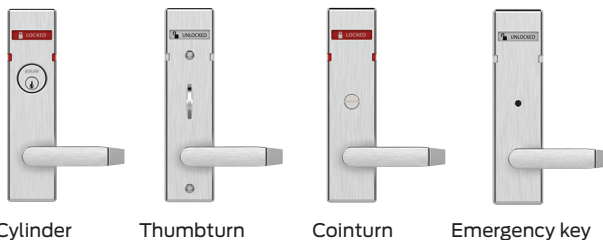





Cylinder Thumbturn Cointurn Emergency key

Sectional indicators



Cylinder Thumbturn Cointurn Emergency key

	 LOCKED	 OCCUPIED	 DO NOT DISTURB	 UNLOCKED
Inside trim	L283-711	L283-712	L283-713	L283-714
Outside trim	L283-721	L283-722	L283-723	L283-724

Legacy indicator



Hotel occupancy indicator

09-611

For lock function L9486P, used with A or B roses on section trim. Three available messages: "OCCUPIED", "DO NOT DISTURB" or "LOCKED".

LE wireless electronic locks

Greenwich

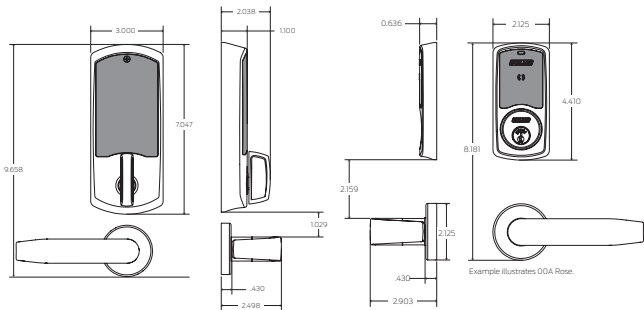

Addison

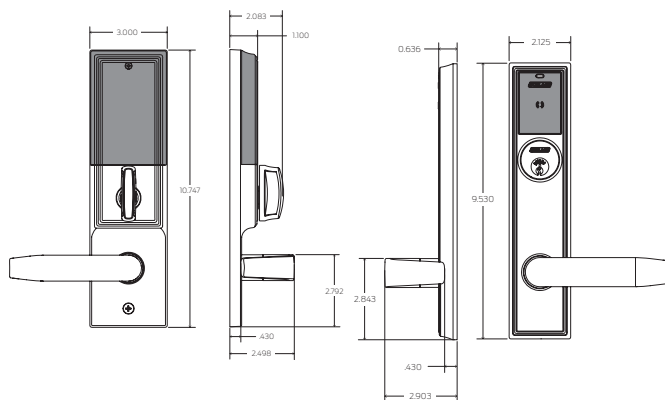

Available status signals

- Request to Exit
- Door position
- Interior cover tamper¹
- Battery status
- Lock/unlock status²
- Communication status¹
- Deadbolt position status (MD only)¹
- Interior pushbutton status (MB only)¹

Multi-technology reader specifications

Frequency	125 kHz proximity and 13.56 MHz smart credential
Standards	ISO standard 15693 and ISO 14443
Maximum read range	Up to 1.25" on 125 kHz proximity, up to 0.75" on 13.56 MHz smart credential

¹ Consult your access control software provider for specific scope of support.

² Software indicates lock/unlock status based on sequence of events.

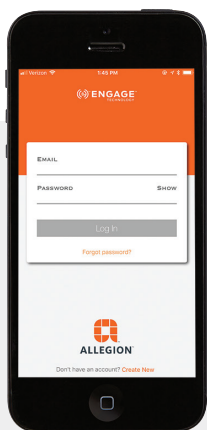

ENGAGE cloud-based web and mobile applications

ENGAGE cloud-based web and mobile apps make it easy to configure lock settings, manage access rights and view audits and alerts from anywhere.



LE wireless electronic lock functions

LEMS**LED Indicator****Storeroom**

- Lockset is normally secure
- Inside lever always free for immediate egress
- Valid toggle credentials on the exterior may be used to change to a passage or secured status
- A mechanical key will momentarily unlock the door

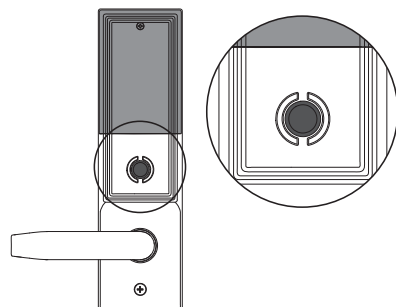
**LEMB****Interior Push Button and LED****Office**

- Lockset is normally secure
- Inside lever always free for immediate egress
- Interior pushbutton on inside housing may be used to select a privacy status
- Interior pushbutton will disable normal electronic access from the exterior
- Opening the door or pressing the interior pushbutton a second time on the inside housing deactivates the privacy status

Apartment

- Lockset is normally secure
- Inside lever always free for immediate egress
- Interior pushbutton on inside housing may be used to select a passage or secured status
- Opening the door or pressing the interior pushbutton causes the lockset to toggle unsecured
- While toggled unsecured, the lockset can only be secured while the door is closed by pressing the interior pushbutton or using a normal credential on the exterior
- Normal electronic access from the exterior is always allowed

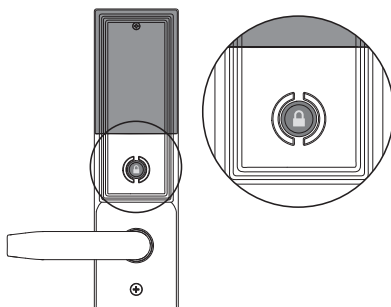
**LEMD****Deadbolt with LED****Privacy**

- Lockset is normally secure from exterior
- Inside lever always free for immediate egress and retracts both latchbolt and deadbolt
- The deadbolt may be used to select a privacy status
- With deadbolt extended, normal electronic access from the exterior will be disabled
- Opening the door or retracting deadbolt deactivates the privacy status

Apartment

- Lockset is normally secure from exterior
- Inside lever always free for immediate egress and retracts both latchbolt and deadbolt
- The deadbolt may be used to select a passage or secured status
- Opening the door or retracting the deadbolt causes the lockset to toggle unsecured
- While toggled unsecured, the lockset can only be secured while the door is closed by extending the deadbolt from inside or using a normal credential on the exterior reader
- Normal electronic access from the exterior is always allowed

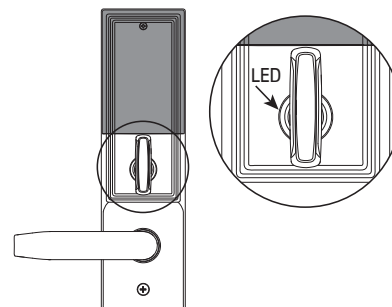

Readers, credentials and power supplies

Readers and credentials

Schlage's comprehensive portfolio of electronic credentials and wall mount readers are designed to provide enhanced levels of security, efficiency and convenience to any facility.

Proximity (125 kHz) technology:

- Basic open contactless technology; recommended for legacy systems only
- Encoded with a unique number that cannot be updated or changed

Smart (13.56 MHz) technology:

- Advanced contactless technology, more secure than magnetic stripe and proximity options
- Advanced data encryption secures against duplication
- Recommended for new systems
- Open platform, designed to work with a wide array of systems and applications beyond access control

Multi-technology options that provide flexibility:

- All multi-technology credentials and readers feature Schlage smart technology with either magnetic stripe or proximity
- Enables migration from legacy platform to secure smart technology
- Reader options available with keypad for high security applications



Credentials

Options include clamshell or ISO cards, keyfobs, wristbands and mobile.

Readers

Single-technology proximity (PR) and smart (SM) readers available in a mini mullion design. Multi-technology (MT) options include mullion, single gang and single gang with keypad (K).

Power supplies

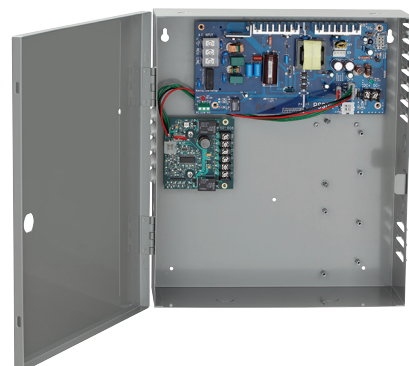

Schlage power supplies are designed for speed and ease of installation upfront with the assurance post installation of the highest quality output in terms of even power flow to protect downstream devices.

Cylinders and key systems

Cylinders and key systems

A strong lock is only part of the security solution—proper key control is equally important. Schlage offers extensive options to meet the security needs of the specific project.

Cylinders



Conventional mortise cylinder options¹

- 6-pin length (standard)
- 7-pin length in SL cylinder
- Available in Schlage Classic and Everest 29™ open and restricted keyways
- Primus® XP security features and geographic exclusivity
- Primus XP UL 437 listed high security features
- Faculty restroom function available



Full size interchangeable core (FSIC) options¹

- 6-pin length
- 7-pin length in SL cylinder
- Available in Schlage Classic and Everest 29 open and restricted keyways
- Interchangeable core compatible with conventional cylinder key systems
- Primus XP security features and geographic exclusivity



Small format interchangeable core (SFIC) options²

- 7-pin combined Everest 29 R restricted keyways³

¹ Available in 606, 622, 626 and 643 plug face finishes; Everest 29 S123 keyway standard.

² Available 606, 622, 626 and 643e finish only.

³ Restricted keyway cores require authorization from the end user.

Key systems

Classic keyway

- Open keyway—keys are duplicated and available without ordering formalities
- Upgradeable to Primus XP and UL 437 levels of security

Everest 29

- Patented through 2029
- Key duplication is restricted providing a higher level of security for the cylinder
- Can be integrated to an existing Everest B, C, or D system
- Upgradeable to Primus XP and UL 437 levels of security

Cylinder mechanism options

Primus XP



- Independent, dual locking mechanisms
- Unique side bit milling on key makes unauthorized duplication highly enforceable
- Allows creation of geographically exclusive keys in thousands of available combinations
- Provides patent protection when applied to Schlage Classic keyways
- Compatible to all Everest and Everest 29 keyways

Everest 29 SL

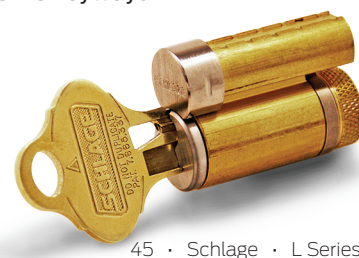
- Available in Conventional and FSIC cylinder formats
- Pinned on an A2 system compatible with the Schlage Everest B and Everest 29 R keyways
- Users can expand existing Everest B and Everest 29 R key systems
- Enables Primus XP upgrades on SFIC keyways



Cylinders and key systems

Administrative Security	Schlage Everest 29™					
	Schlage Classic	End user exclusive nationwide	4N		9N	
		End user exclusive within time zone/country	4Z		9Z	
	End user exclusive within zip code		3G		9G	
	End user controlled; non-exclusive		3U		9U	
	Dealer exclusive within time zone/country		2		8	
	Dealer exclusive within zip code		1+		7	
	Authorized dealer only; non-exclusive		1			
Mechanical	End user controlled; non-exclusive		Primus XP RESTRICTED Schlage Everest 29 R FSIC ² and Conventional ²		UL 437 Option UL listed security improvements available with Primus XP	
	Authorized dealer only		Primus XP RESTRICTED Schlage Classic FSIC and Conventional			
	No authorization		RESTRICTED Schlage Everest 29 R ¹ FSIC, FSIC ² and Conventional ² Schlage Everest 29 T FSIC and Conventional			
	OPEN Schlage Classic FSIC and Conventional		OPEN Schlage Everest 29 S FSIC and Conventional			
Wired electrified	<ul style="list-style-type: none"> Duplicate anywhere 		<ul style="list-style-type: none"> Patented design Check pin in cylinder 		<ul style="list-style-type: none"> Hardened steel drill pins Proven pick and drill resistant Withstands extreme physical attack 	
	<ul style="list-style-type: none"> Patented design Check pin in cylinder 		<ul style="list-style-type: none"> Requires letter of authorization Patented design Check pin in cylinder 			
	<ul style="list-style-type: none"> 5 levels of side bit milling exclusivity Patent protection to 2024 Independent sidebar and finger pin locking mechanisms 		<ul style="list-style-type: none"> 5 levels of side bit milling exclusivity Patent protection to 2029 Independent sidebar and finger pin locking mechanisms 			
	<ul style="list-style-type: none"> 5 levels of side bit milling exclusivity Patent protection to 2029 Independent sidebar and finger pin locking mechanisms 					
Physical Security						

COMPARABLE ELECTRONIC SECURITY - Ensure your credential is as secure as your keyway		
Proximity credentials <ul style="list-style-type: none"> Easily duplicated 	MIFARE Classic® smart credentials <ul style="list-style-type: none"> Secure encrypted data and communications Difficult to duplicate 	MIFARE Plus® and MIFARE® DESFire® EV1 smart credentials <ul style="list-style-type: none"> Advanced data encryption makes duplication nearly impossible Most secure credentials available from Schlage

1. Limited dealer controlled programs available.
 2. FSIC and Conventional in the form of SL cylinders that accept an SFIC key.

Primus XP access control and high security cylinders

Primus XP access control and high security cylinders are available to add patented key control and varying degrees of geographical exclusivity to most Schlage 6- and 7-pin key systems, whether Everest 29 or Classic keyways.

In addition to a standard pin tumbler mechanism, Primus cylinders incorporate a patented finger pin and sidebar design, providing a “dual-locking” cylinder that is virtually pick-proof. Resistance to drilling and other physical attack is optional by specifying 20-500 Series UL 437 Listed high security cylinders.

Classic Primus XP cylinders are recommended for upgrading existing Classic key systems. Due to its extended patent life, Everest 29 Primus XP is recommended for new key systems and for upgrading existing Everest key systems. Specify keyway to differentiate between Everest 29 and Classic. Example: C or CP (Classic) vs. S123 (Everest 29).

Full size interchangeable cores

FSIC mortise cylinders

Schlage figure-8 interchangeable core (IC) cylinders allow immediate rekeying at the door. Simply use the special control key to replace the core in seconds. Full-size IC cylinders can be integrated into any existing 5- or 6-pin Schlage key system with no adverse effects on keying capacity. Convert existing mortise locks to interchangeable core merely by replacing the old cylinder with the IC cylinder and proper collar(s).

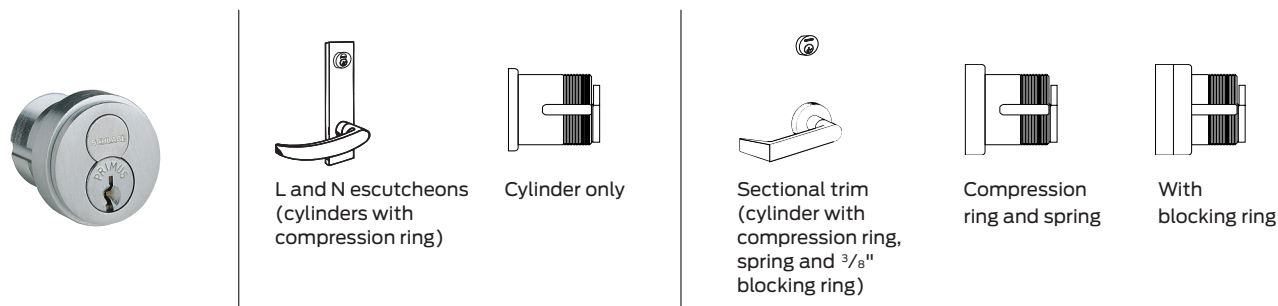

FSIC cylinders for Schlage L Series mortise locks

Design	Function	Core mechanism				
		Standard pin and tumbler	SL cylinder ¹	Primus Primus XP	Primus XP SL cylinder ¹	Housing less core
L and N escutcheons (cylinders with compression ring)	All except below	30-008	91-163	20-798 20-798-XP	91-863-XP	30-007
	L9060 outside	30-030	91-165	20-782 20-782-XP	91-865-XP	30-032 + 36-083
	L9485, L9486 faculty restroom	30-010 ²	N/A	N/A	N/A	N/A
Sectional trim (cylinder with compression ring, spring and 3/8" blocking ring). 9060 requires 1/2" blocking ring.	All except below	30-138	91-169	20-776 20-776-XP	91-869-XP	30-137
	L9060 outside	30-030 + 36-082-050	91-165 + 36-082-050	20-783 20-783-XP	91-865-XP + 36-082-050	30-032 + 36-083 + 36-082-050
	L9485, L9486 faculty restroom	30-140 ²	N/A	N/A	N/A	N/A

¹ For restricted Everest 29 R and Everest B only.

² Faculty restroom function cores are handed. Specify hand of door.

Finishes: 605, 606, 609, 612, 613, 619, 622, 625, 626, and 643e.

Standard cylinder length is 1 1/2".

FSIC, core only, cylinders

Number	Pins	Cylinder mechanism
23-030	6	Standard pin and tumbler
23-031	6	Standard pin and tumbler, less logo
91-161	7	SL cylinder (restricted Everest 29 R and Everest B only)
91-162	7	SL cylinder, less logo (restricted Everest 29 R and Everest B only)
20-740	6	Primus
20-741	6	Primus, less logo
20-740-XP	6	Primus XP
20-741-XP	6	Primus XP, less logo
91-861-XP	7	SL cylinder (restricted Everest 29 R and Everest B only)
91-862-XP	7	SL cylinder, less logo (restricted Everest 29 R and Everest B only)
30-120	6	Faculty restroom standard pin and tumbler (specify hand)
30-121	6	Faculty restroom standard pin and tumbler, less logo (specify hand)

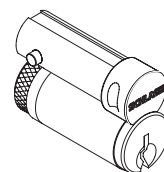

Finishes: 606, 622, 626 and 643e only.

Standard keyway: 6-pin Everest 29 S123 for stock, S145 for new master key systems.

Small format interchangeable cores

SFIC mortise cylinders

The L Series lockset can be ordered to accept small format interchangeable cores (SFIC) compatible with manufacturers such as Falcon, Arrow and Best; cams are easily changeable.

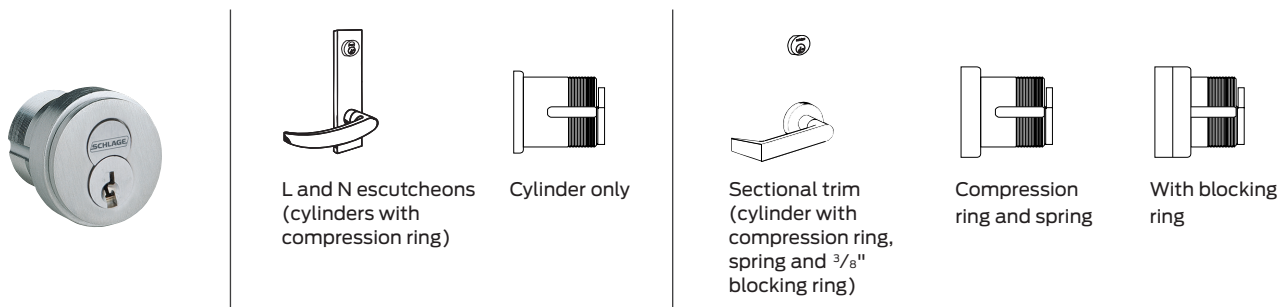

SFIC cylinders for Schlage L Series mortise locks

Design	Function	Core mechanism			
		Everest 29 restricted (GD suffix)	Keyed construction (HD suffix)	Disposable construction (BDC suffix)	Housing less core (BD suffix)
L and N escutcheons (cylinders with compression ring and spring)	All except L9060 outside	80-308	80-138	80-115	80-108
	L9060 outside	80-304	80-134	80-112	80-104
Sectional trim (cylinder with compression ring, spring and 1/4" blocking ring).	All except L9060 outside	80-301	80-131	80-109	80-101
	L9060 outside	80-304 + 36-082-050	80-134 36-082-050	80-112 36-082-050	80-104 36-082-050

Notes

- Available in 605, 606, 609, 612, 613, 619, 625, and 626 finish. Cores furnished 606 and 626 only.
- All cylinders are 1 3/8" long.

Small format core only

Number	Mechanism
80-036	7-pin Everest 29 R family restricted keyway core uncombined
80-037	7-pin Everest 29 R family restricted keyway core combined
80-043	6-pin best keyway core, uncombined
80-033	7-pin best keyway core, uncombined

Notes

- Available in 606, 613 and 626 finish only. 80-043 and 80-033 available in 606 and 626 only.
- Suffix keyway, e.g. 80-036 B235, 80-043 AB, etc.
- Proper authorization required for Everest 29 cores. Order control keys separately.
- 80-043 and 80-033 available in Best A, D, E, F, G, H, J, K, L and M keyways. Suffix "B" to keyway letter, e.g. AB, DB, etc.

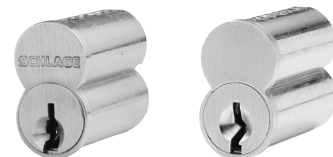

Parts and options

Blocking and compression rings

36-079



Blocking ring.
Specify finish
and dimension.
Not to be used
with 36-083.

36-082



Blocking ring.
Specify finish
and dimension.
Use with 36-083.

36-083

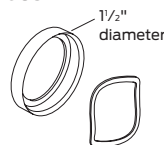

Compression ring
and spring. Specify
finish and dimension.

L538-195



Compression
spring.

Blocking ring dimensions

Ring length	Dimension
1/8"	012
3/16"	018
1/4"	025
5/16"	031
3/8"	037
7/16"	043
1/2"	050

FSIC core blocking ring requirements

Function	Trim	Door thickness			
		1 3/8"	1 3/4"	2"	2 1/4"
Dimension					
L9050, L9056, L9070, L9076, L9080, L9092EL/EU, L9453, L9456, L9460 per XL11-886 or XL11-635, L9464 per XL11-886, L9465, L9473, L9480	Rose	050	037	025	025
	Escutcheon	025	012	N/R	N/R
L9485 per XL11-557	Rose	—	037	025	025
	Escutcheon	—	012	N/R	N/R
L9486, L9496	Rose	012	N/R	N/R	N/R
	Escutcheon	025	012	N/R	N/R
L9060, L9071, L9077, L9082, L9457, L9462 per XL11-886, L9466, L9482	Rose	—	050	043	031
	Escutcheon	025	012	N/R	N/R
L460, L464, L496, L9460, L9464	Rose trim	050	037	025	025
L462, L463, L9462, L9463	Rose trim	—	050	043	031

SFIC blocking ring requirements

Function	Trim	Door thickness			
		1 3/8"	1 3/4"	2"	2 1/4"
Dimension					
L9050, L9056, L9070, L9076, L9080, L9092EL/EU, L9453, L9456, L9460 per XL11-886 or XL11-635, L9464 per XL11-886, L9465, L9473, L9480	Rose	037	025	012	N/R
	Escutcheon	N/R	N/R	N/R	N/R
L9060, L9071, L9077, L9082, L9095EL/EU, L9457, L9462 per XL11-886, L9464, L9466, L9482	Rose	—	050	037	025
	Escutcheon	018	N/R	N/R	N/R
L9496	Rose	025	012	N/R	N/R
	Escutcheon	N/R	N/R	N/R	N/R
L460, L464, L496, L9460, L9464	Rose trim	037	025	012	N/R
L462, L463, L9462, L9463	Rose trim	—	050	037	025